

1. All boundaries, dimensions and levels are to be checked on site before construction and any discrepancies are to be reported to the Architect.  
 2. Do not scale from this drawing other than for planning purposes.  
 3. Drawings not supplied in paper format by A+G architects Ltd may not be to the scale indicated in the size box.  
 4. This drawing is copyright and may not be reproduced or used for any purpose other than that intended without prior written agreement from A+G architects.  
 5. Any parts of the drawing based on Ordnance Survey maps are executed with the sanction of the controller of H.M. Stationery Office - Crown Copyright Reserved.

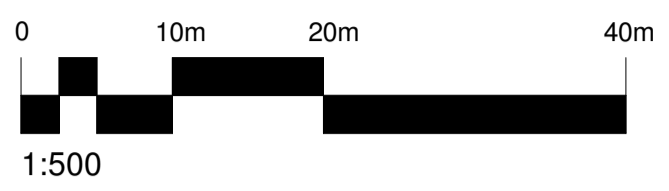

**NOTES**  
 Landscaping shown outside the site boundary is based on infrastructure landscaping plans 02.18/04 Rev.F and 02.18/05 Rev.F and is approximate and indicative only.  
 Soft landscaping within the site shown indicatively only - see Landscape Architects Drawings for layout and details.

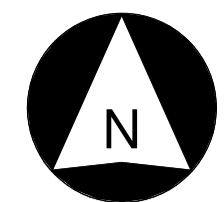
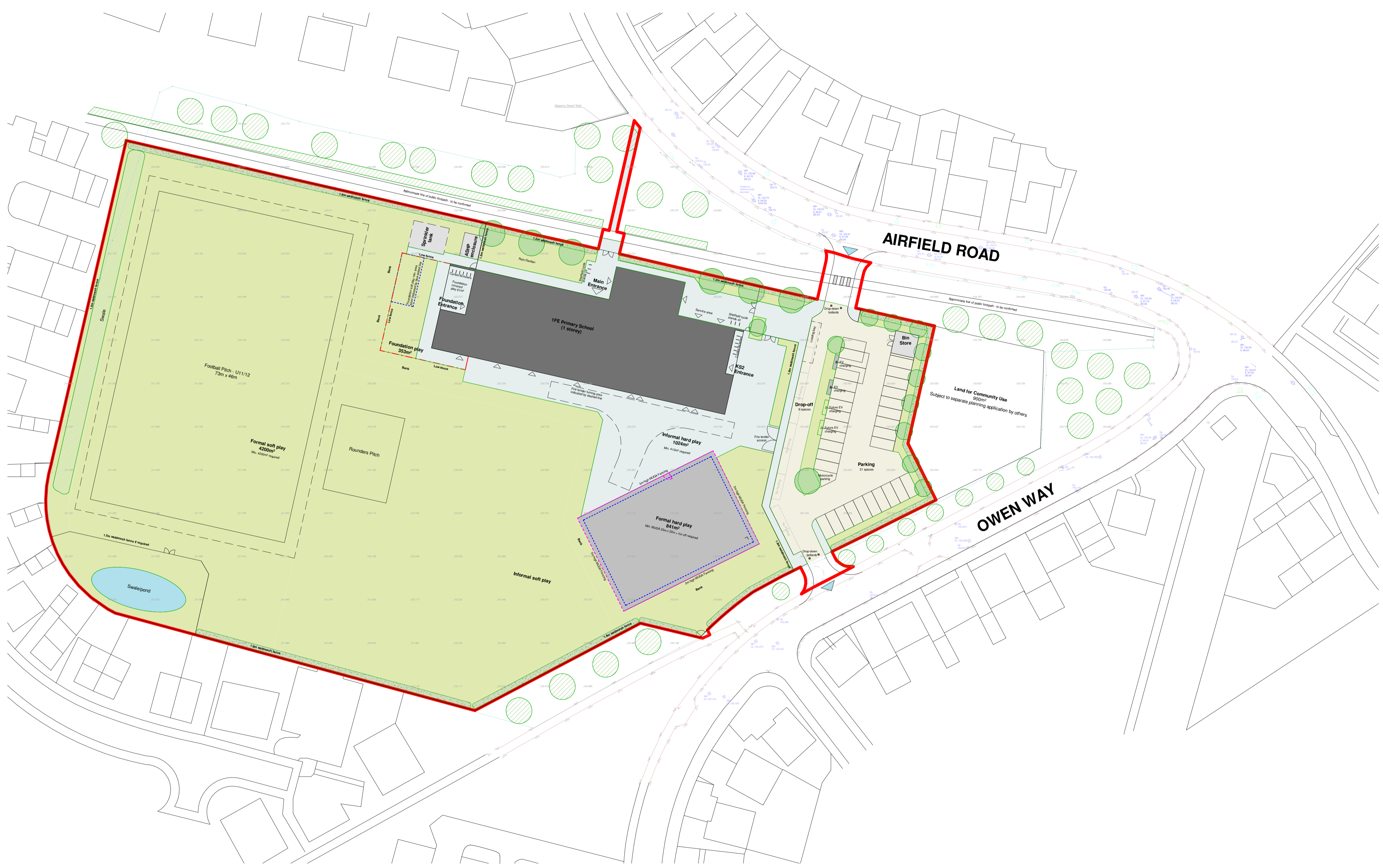

P07	02.03.23	Red line boundary revised	JC	JC
P06	27.02.23	Drop-off revised, Soft landscaping added	JC	JC
P05	16.02.23	Car park revised; Access road widened; Adjacent planting indicated; Title block revised	JC	JC
P04	30.01.23	Pond position revised	JC	JC
P03	30.01.23	Revision in line with LCC comment	JC	JC
P02	25.01.23	D1 redesign	JC	JC
P01	11.01.23	Preliminary Issue	JC	JC
Rev	Date	Description	By	CHK

**PRELIMINARY**

**A+G architects**

11 Leicester Road • Loughborough  
 Leicestershire • LE11 2AE  
 t: 01509 212310  
 e: email@aandgarchitects.com  
 w: www.aandgarchitects.com

Client:  
 Leicestershire County Council &  
 Willmott Dixon Construction Limited

Project:  
 Airfield Farm Primary School  
 Airfield Farm Development  
 Market Harborough

Drawing title:  
 Proposed Site Plan  
 1FE (Extendable)

Drawing no: <b>M00504-A&amp;G-XX-XX-DR-A-0104</b>			
A+G Reference No.:	First Issue:	Rev:	
<b>L2223</b>	11.01.22	<b>S1-P07</b>	
Scale(s):	Size:	Drawn:	Checked:
1 : 500	A1	JC	JC

**1 Proposed Site Plan\_1FE Extendable**  
 1 : 500